

R50 SERIES

This midget end view tube was designed for applications where space limitation is the controlling factor. Especially adaptable to extremely small electronic control devices.

Ideal in use of multiple phototube banks for controlling the moving pattern of electric signs.

This miniature tube fits perfectly with the compact designs of coin operated machines.

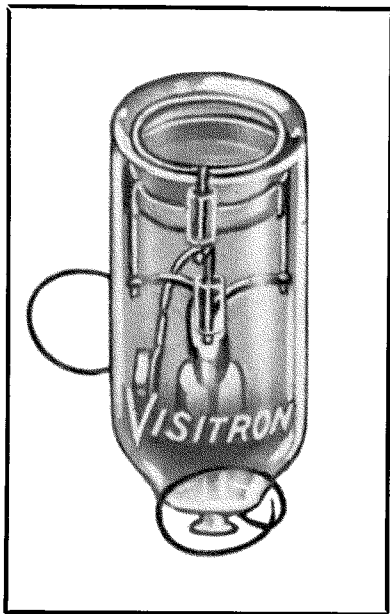

TYPE R50

GENERAL CHARACTERISTICS

	<u>R50A</u>	<u>R50AV</u>
Cathode Surface	S1	S1
Cathode Size	.500" Dia.	.500" Dia.
Capacitance (Anode-Cathode)	2.5 MMF.	2.0 MMF.
Leakage Resistance (Min.)	1000 Meg.	1000 Meg.

MAXIMUM RATINGS

	<u>R50A</u>	<u>R50AV</u>
Anode Voltage, Peak	90V	500V
Luminous Sensitivity	200 μ A/L DC	35 μ A/L DC
Luminous Sensitivity (25v)	30 μ A/L DC	30 μ A/L DC
Gas Amplification	10	---
Temperature, ambient	100°C	100°C

USABLE PLATE

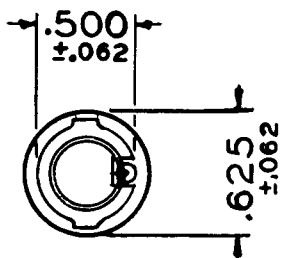

DIRECTION OF LIGHT

